

If a combustible mantle is to be installed, do not install it closer than a minimum of 508mm (20") above the fireplace opening as shown in figure 8.

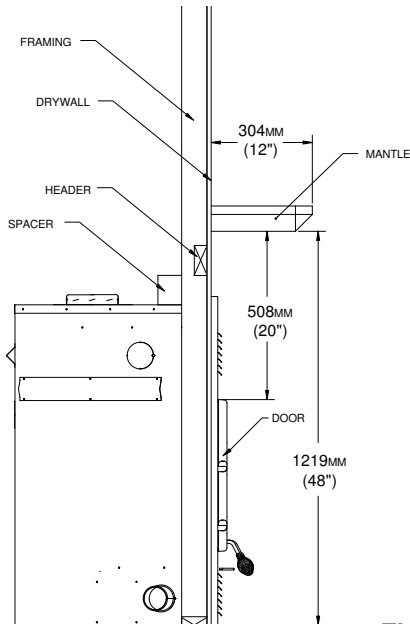

FIGURE 8

CHIMNEY INSTALLATION INSTRUCTIONS

The minimum approved system height is 4.3m(14') above the fireplace. The fireplace is designed to support up to 7.6m(25') of vertical chimney. For greater heights additional supports are required at each 8.0m(24').

Except for installation in one and two family dwellings, your chimney that extends through any zone above that on which the connected appliance is located, is to be provided with an enclosure having a fire resistance rating equal to or greater than that of the floor or roof assemblies through it passes.

Authorities require that the chimney extend not less than 1m(3') above the highest point where it passes through the roof of a building and not less than 609mm(2') above any portion of the building within 10'. See figure 9.

The use of locking bands or stainless sheet metal screws (#6 x 3/4") should be used on all interior joints. Locking bands must be used on all sections that make up an offset and exterior joint.

Figures 11-14 shows the four basic types of installations most likely to be encountered when installing a Model HE40 fireplace system.

FIGURE 9

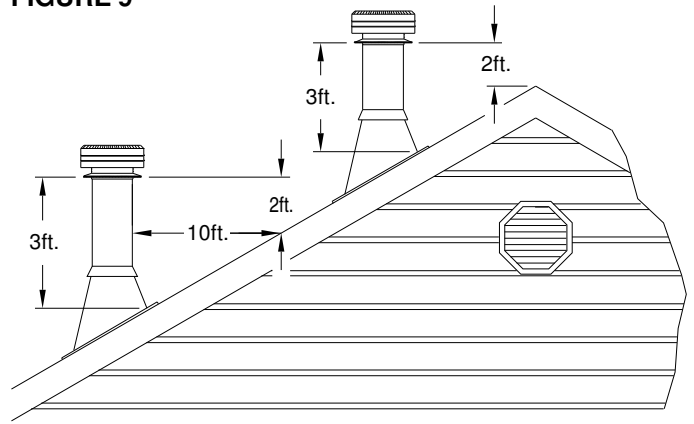

CHIMNEY FRAMING DETAILS

Plan your chimney installation carefully. Lay out and frame in the required openings, ensuring the specified 50mm(2") clearance to combustibles is maintained. All openings should be square, plumb, and in perfect alignment with each other. See figure 10a.

For sloping roofs, ensure that the framing dimension is measured in the horizontal plane. See figure 10b.

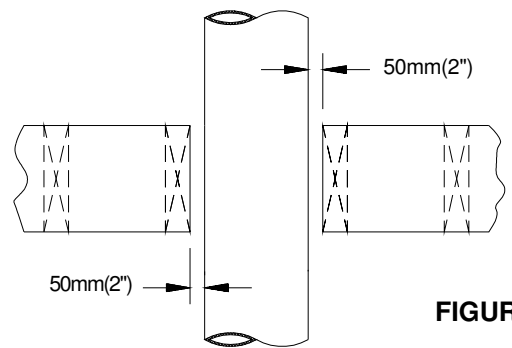

FIGURE 10a

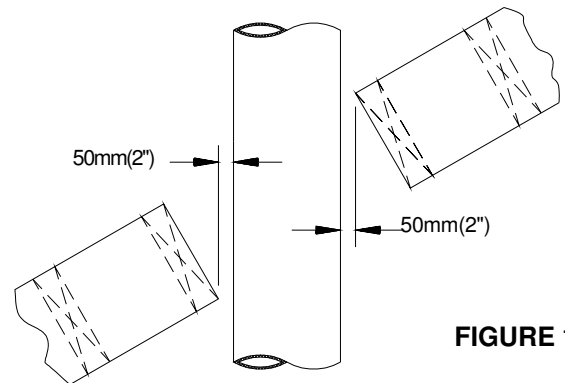

FIGURE 10b

RADIATION / DUST SHIELD

All joint areas must be fully framed to accept a Radiation / Dust Shield. The SS Radiation / Dust Shield must be used at all joist levels except an open attic level. Use 1-1/2" nails to attach it to the joists. The shield may be trimmed but must remain 25mm (1") below or above the ceiling.

MODELS SUPERCHIMNEY / SUPERPRO CHIMNEYS

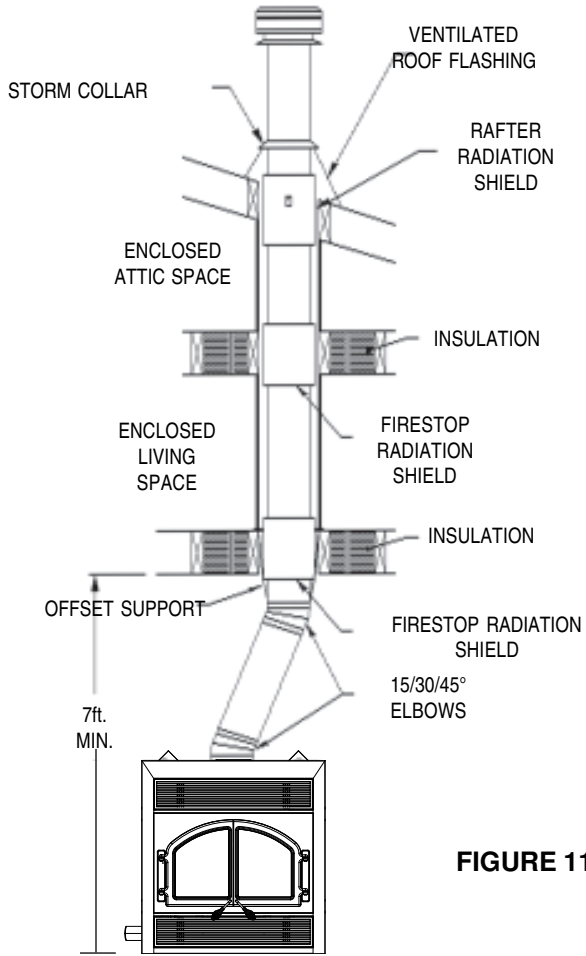

FIGURE 11a

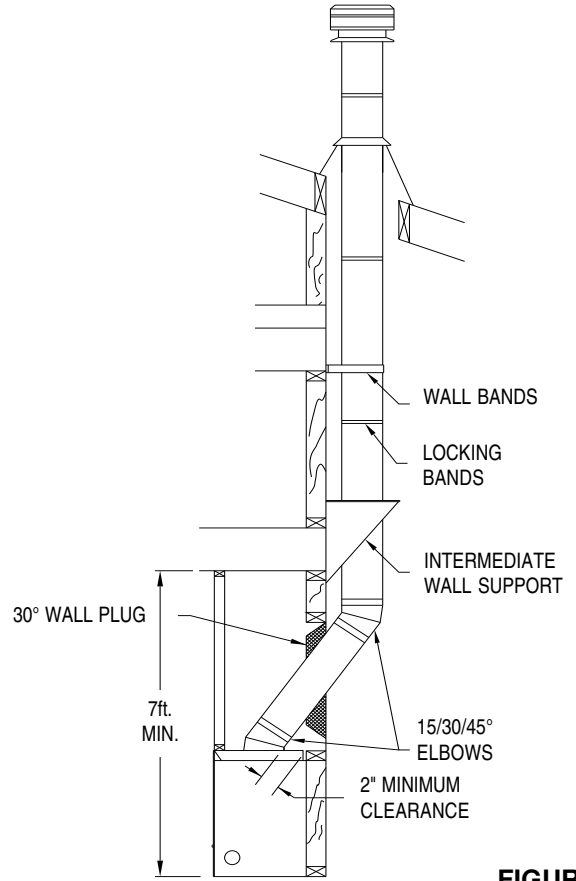

FIGURE 11c

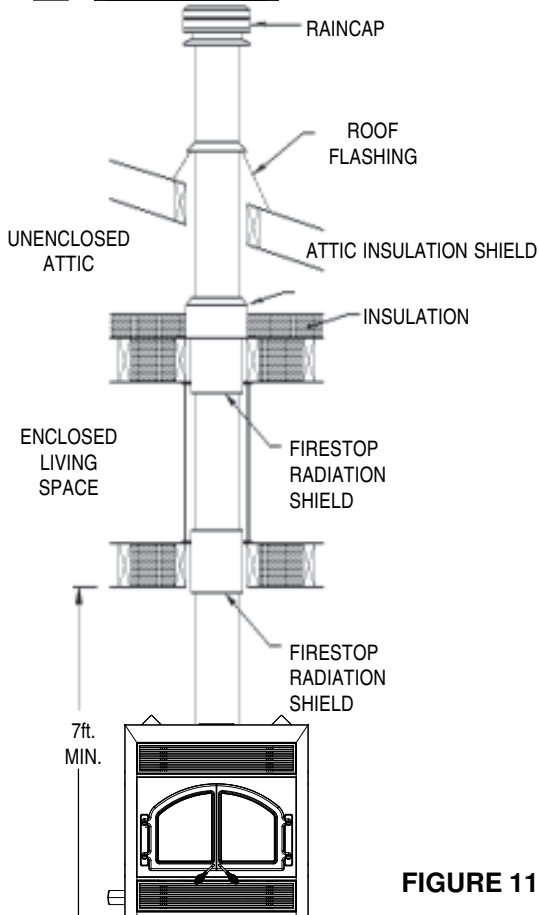

FIGURE 11b

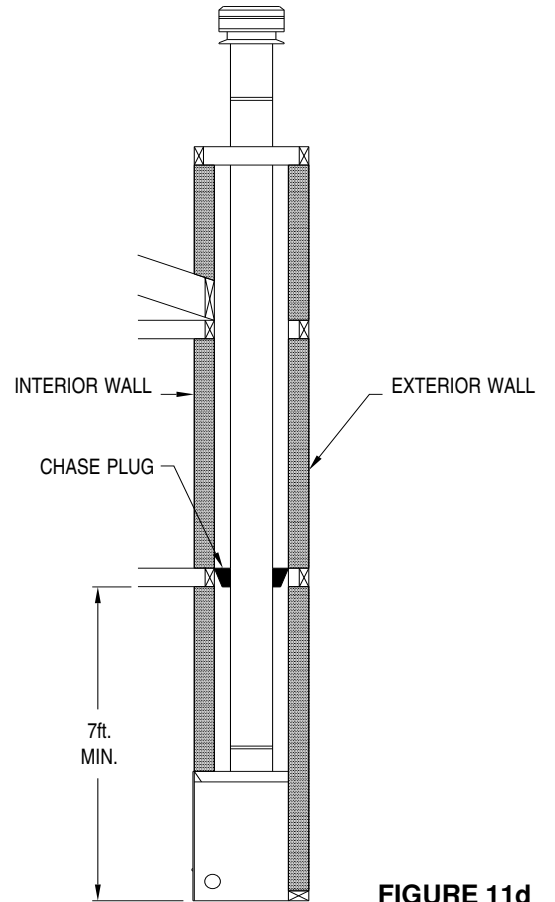

FIGURE 11d

**MODELS SUPERCHIMNEY 2100 / SUPERPRO 2100
CHIMNEYS**

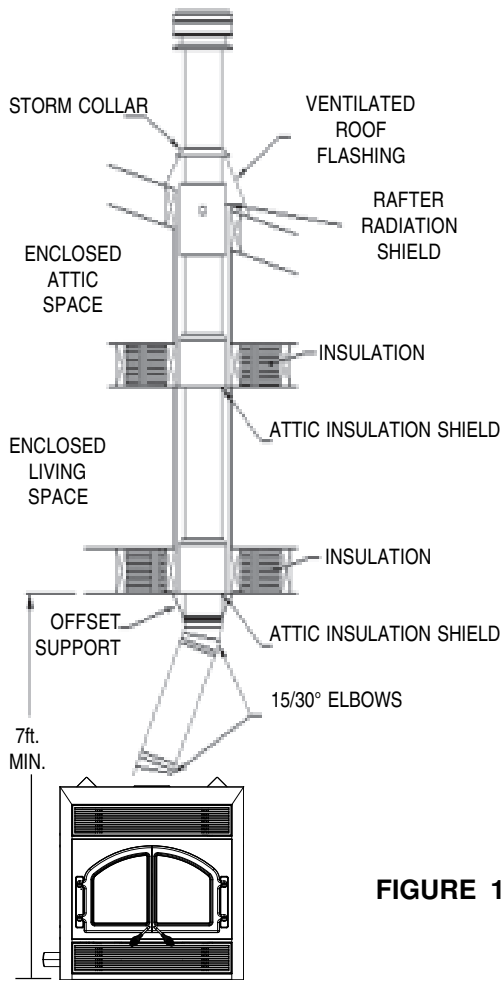

FIGURE 12a

MODEL CF CHIMNEY

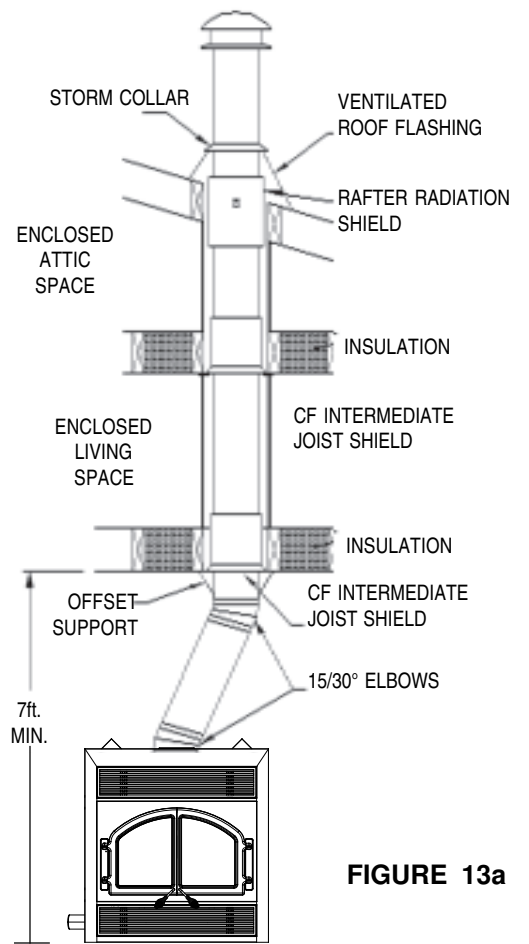

FIGURE 13a

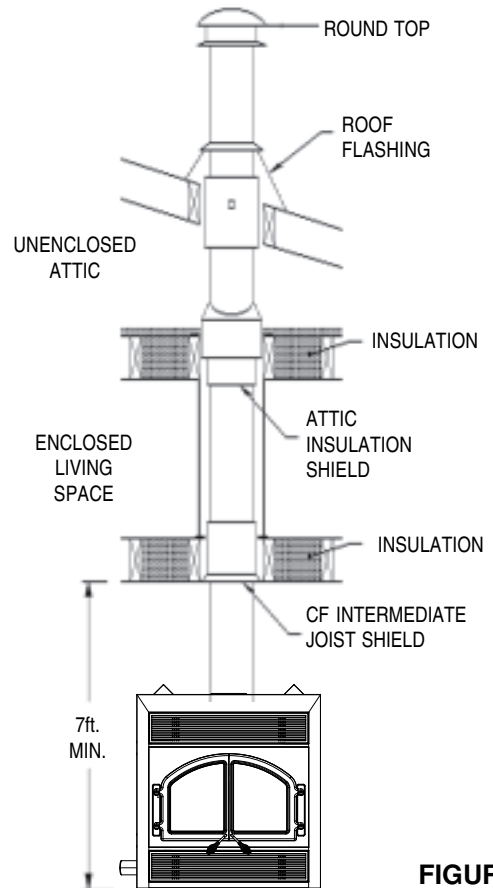
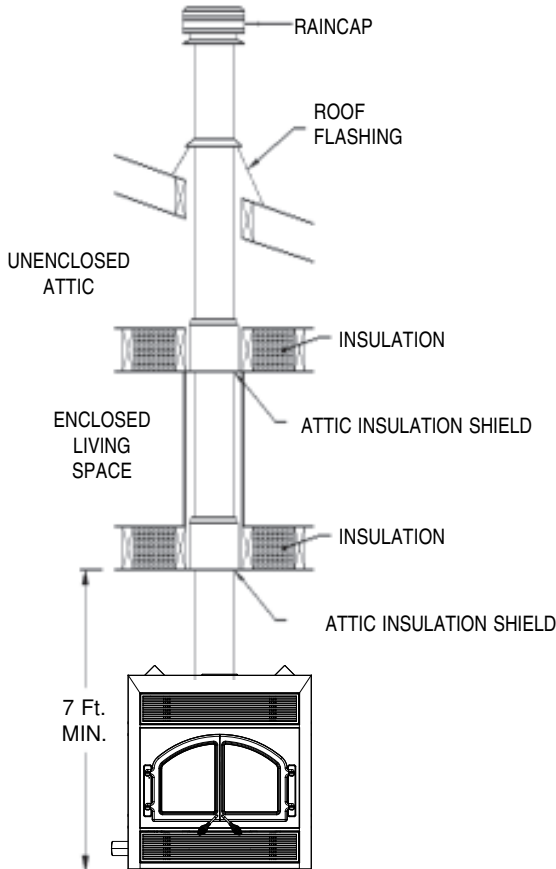

FIGURE 13b

MODEL SS PLUS CHIMNEY

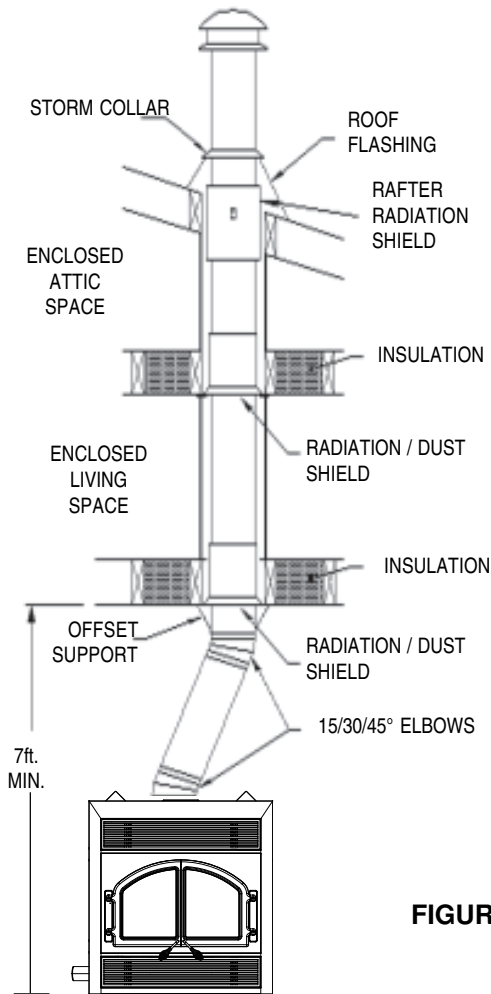

FIGURE 14a

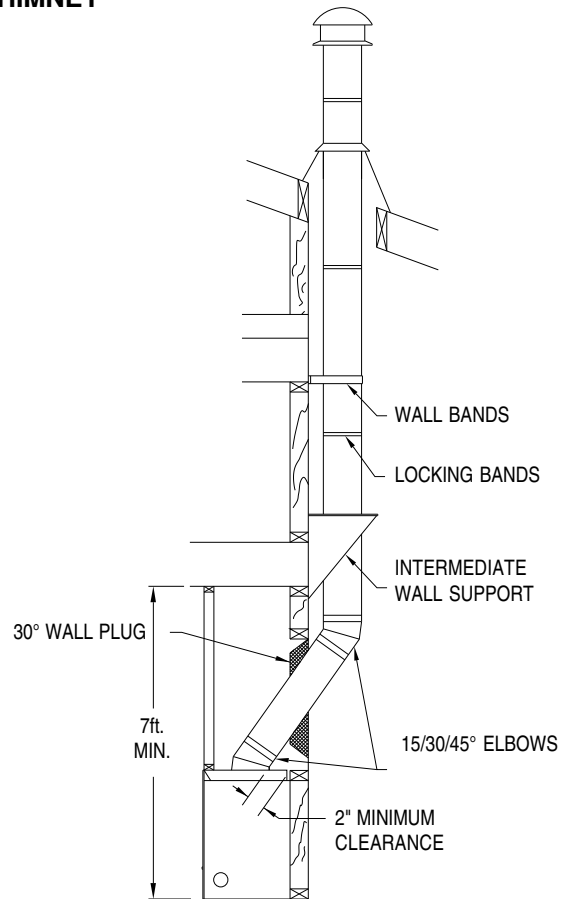

FIGURE 14c

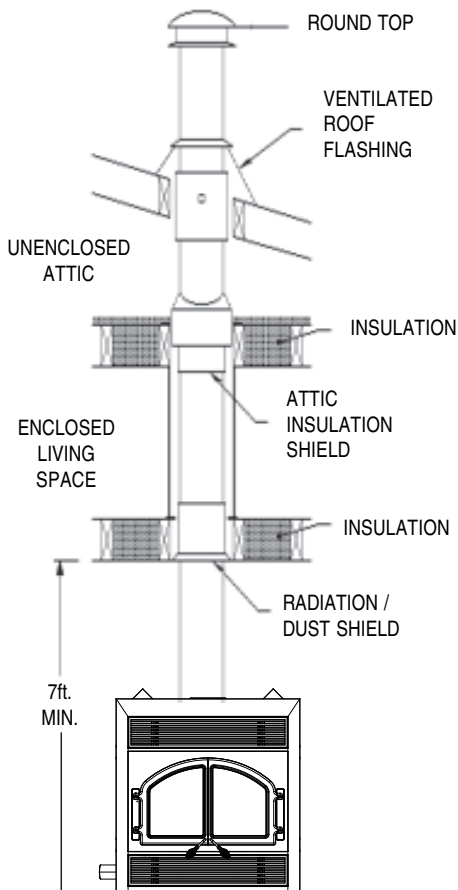

FIGURE 14b

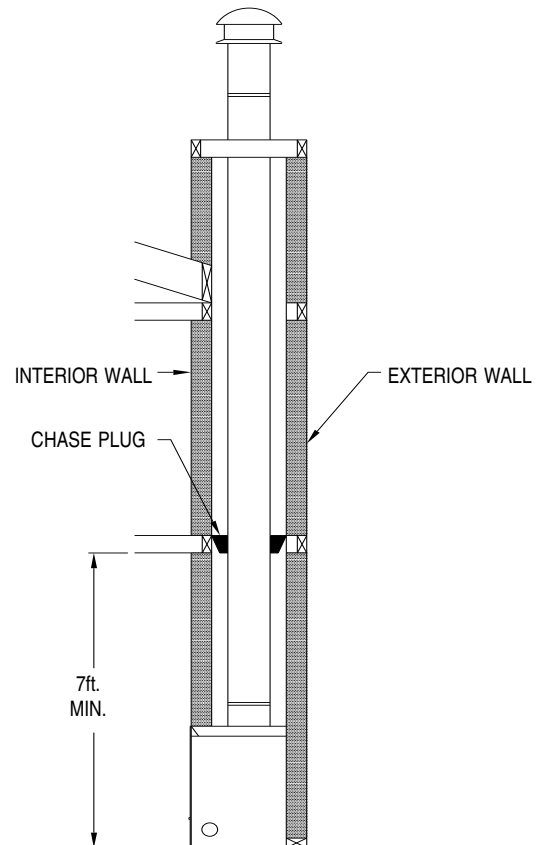

FIGURE 14d

ATTIC INSULATION SHIELD / FIRESTOP SPACER

(Selkirk Model SS Plus & CF)

This shield has three main components: the Attic Insulation Shield (upper box), the Support Angles and the Joist Shield. This complete shield must be used at the ceiling level entering an attic to prevent insulation from coming into contact with the chimney. It is not used when the chimney is tightly enclosed up to the roof. It also firestops this level and because it is a firestop, DO NOT CUT the upper box.

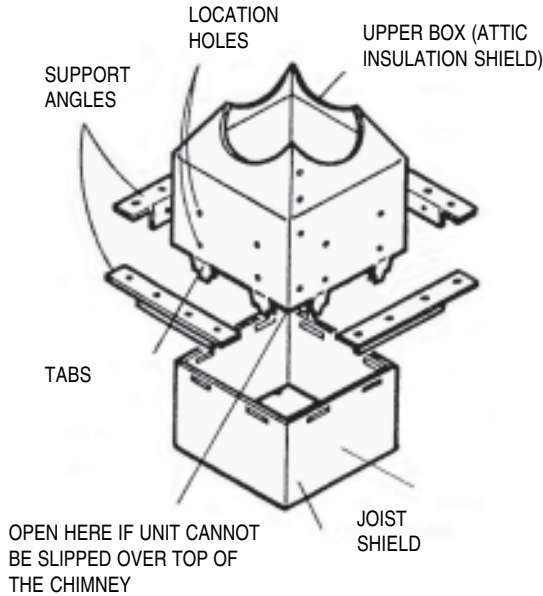

FIGURE 15

FIRESTOP RADIATION SHIELD INSTALLATION

(Supervent Model SC, & SPR)

The Firestop Radiation Shield must be installed whenever the chimney passes through a floor or ceiling from one living space to another living space. The Firestop Radiation Shield has been tested and approved to be installed from either above or below the joist. See figure 11.

If installing the Firestop Radiation Shield from below the joist, ensure that there is no insulation or other combustibles within the 50mm(2") air space around the chimney. This includes the air spaces between the Firestop Radiation Shield and the joist.

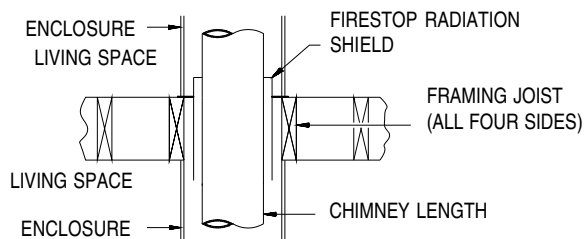

FIRESTOP INSTALLED ABOVE THE JOIST

FIGURE 16a

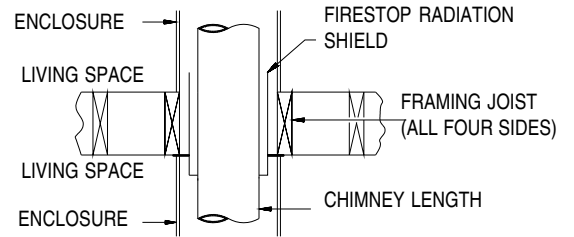

FIRESTOP INSTALLED BELOW THE JOIST

FIGURE 16b

RADIATION / DUST SHIELD INSTALLATION

(Selkirk Model SS Plus)

All joist areas must be fully framed to accept a Radiation / Dust Shield. The SS Radiation/Dust Shield must be used at all joist levels except an open attic level. Use 1-1/2" nails to attach it to the joists. The shield may be trimmed but must remain 25mm (1") below the ceiling.

CF INTERMEDIATE JOIST SHIELD INSTALLATION

(Selkirk Model CF)

The CF Intermediate Joist Shield must be used at all joist levels except an open attic level. It is installed from below using 1-1/2" nails. It cannot be cut down.

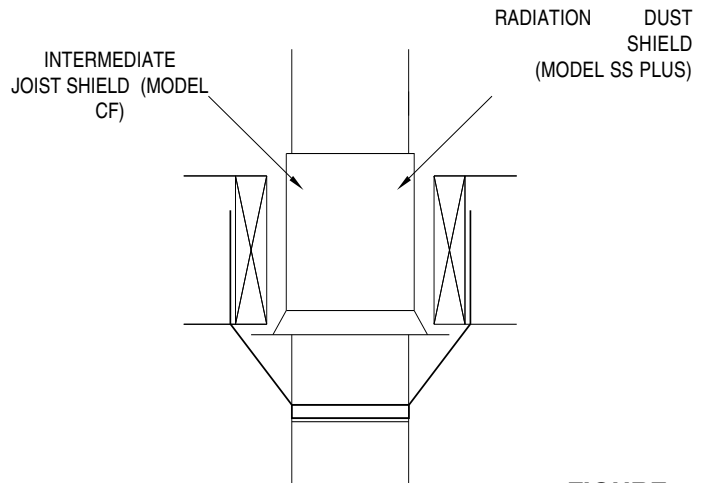

FIGURE 17

ATTIC INSULATION SHIELD INSTALLATION

(Supervent Models SC, SPR, SC-1 and ALT)

An Attic Insulation Shield must be installed where the chimney passes from the lower living space to an upper enclosed attic space. It is designed to keep insulating materials away from the chimney and will protect up to 250mm(10") thickness of insulation. In Canada the Attic Insulation Shield is installed along with the firestop as shown in Figure 18a. In the United States the Attic Insulation Shield is installed as shown in Figure 18b.

(SUPERVENT MODEL SC, & SPR)

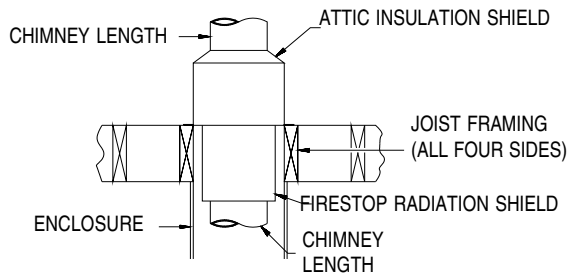

FIGURE 18a

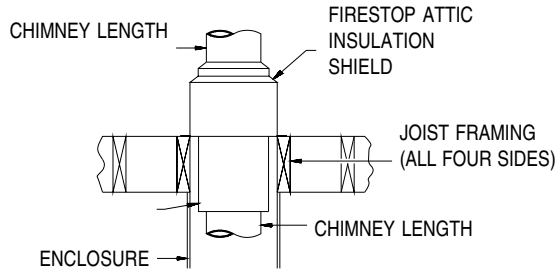

FIGURE 18b

(Supervent Model SC-1, & ALT)

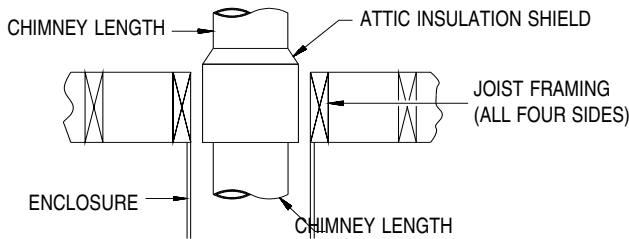

FIGURE 18c

CHASE PLUG INSTALLATION

(Selkirk and Supervent)

The Chase Plug is designed and manufactured to maintain the thermal envelope of your house. The Chase Plug must be installed from the bottom side of a 13"(330mm) square opening using 8 -2"(6d) spiral nails. See figure 19.

Whenever the chase plug is used, the chimney must be enclosed immediately above the joist in which the chase plug is installed.

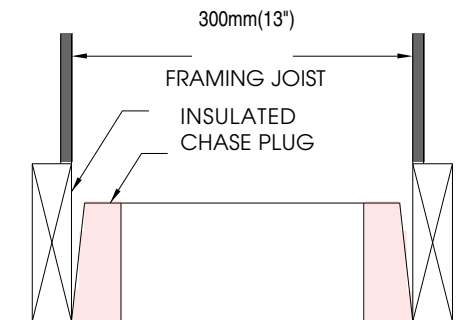

FIGURE 19

ELBOW INSTALLATION

(Supervent Model SC, SC-1, SS Plus, SSII, SPR, ALT & CF)

For offset installations of the 1 inch chimney (SC, SPR, SS Plus) a maximum of 2-45° and 2-15° or 4-30° elbows may be used. For offset installations of the 2 inch chimney (SC-1, ALT, CF) a maximum of 4-30° elbows may be used.

During installation of elbows, make sure to provide supplementary support for the offset sections to avoid any undue stress on connected elbows.

Never install an elbow in a joist area. Chimney sections must pass vertically through framed joist areas.

Install an elbow support just above the highest elbow. Attach the support band to the chimney by installing eight sheet metal screws through the pre-punched holes. Nail the four support bands to the side of the framing using 6d(2") spiral nails. Each elbow support will support 8m(30ft.) of chimney. See figure 20.

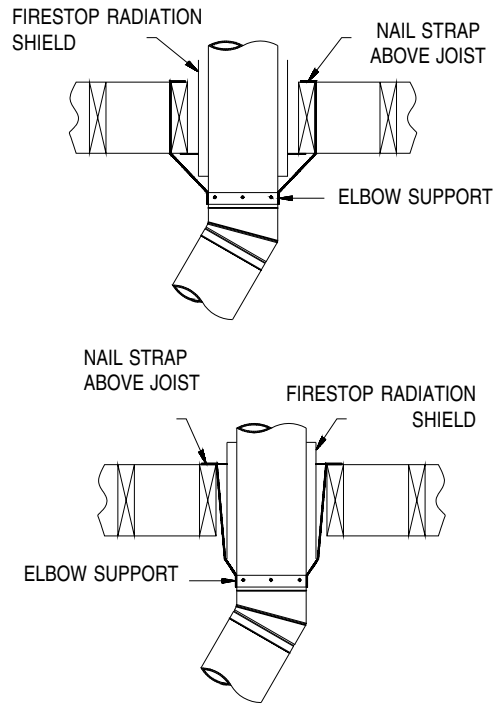

FIGURE 20

OFFSET SUPPORTS

(Model SS Plus, SSII)

Support for a chimney offset need not be immediately above offset, but must be within 6m (20') of the lower elbow of an offset. Supports can hold up to 9m (30') of chimney, 6m (20') of which can be suspended. Two supports are offered with the HE40; they are the SS Interior Resupport and the CF Roof Support.

SS INTERIOR RESUPPORT

The SS Interior Resupport can be put below a Radiation/Dust Shield or an Attic Insulation Shield/Firestop Spacer. It must extend at least 304mm (12") below the top of the joist. Drill 3/32" holes first and use eight (8) #6-3/4" stainless sheet metal screws to attach the band to the chimney. Next nail the straps to the joist (outside of the joist for Attic Insulation Shield/Firestop Spacer) using 1-1/2" common or spiral nails.

OFFSET SUPPORTS

(Model CF)

Two supports are offered for the CF chimney; They are the CF Interior Resupport and the CF Roof Support, described as follows:

CF ROOF SUPPORT

The CF Roof Support can be used with either the SS chimney (see Figure 21a) or the CF chimney (see Figure 21b). The CF Roof Support is located on top of the joists and is installed after an Intermediate Joist Shield is installed (when required). Install two (2) carriage bolts per chimney plate in the square holes. Bend the plates to suit the curve of the chimney. Using the plate as a template drill 3/32" holes in the casing. Attach the plates using the stainless sheet metal screws provided. Attach the Roof Brackets to the chimney plates using the installed carriage bolts. Set the assembly into position and adjust and tighten the carriage bolts. Screw the plate to the joist using the (6) large wood screws per bracket. The Resupports can hold up to 9m (30') of chimney, 6m (20') of which can be suspended.

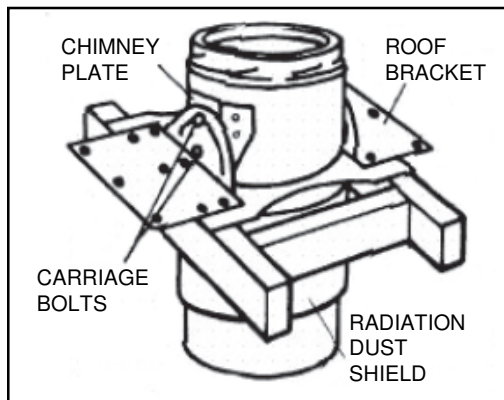

FIGURE 21a

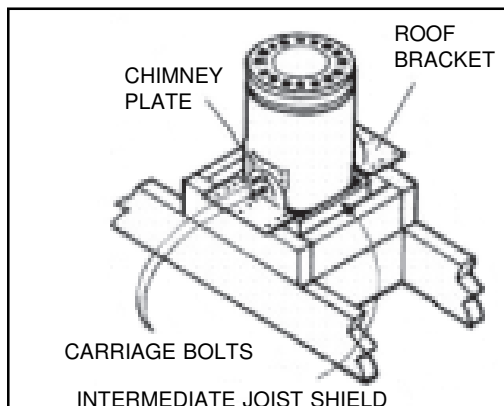

FIGURE 21b

CF INTERIOR RESUPPORT/OFFSET SUPPORT

The CF Interior Resupport/Offset Support can be put below an Intermediate Joist Shield or an Attic Insulation Shield/Firestop Spacer. The Interior Resupport band is attached and tightened below a Locking Band. The straps are then run along the outside of the joists and nailed to them using eight (8) 1-1/2" nails (2 per strap).

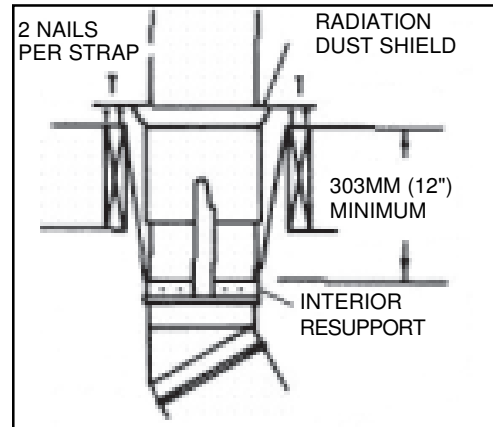

FIGURE 22a

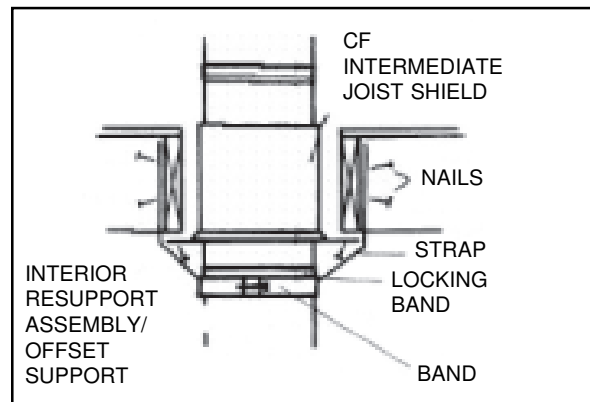

FIGURE 22b

CHIMNEY ADAPTER INSTALLATION

(Model SC, SC-1, SPR, ALT, SS Plus)

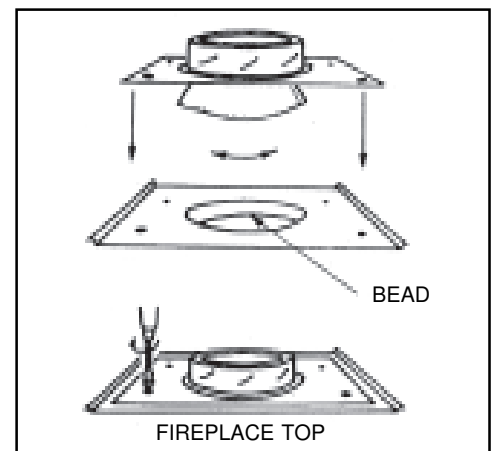

FIGURE 23

Place Adapter over opening at top of your Model HE-40 Fireplace.

Twist the Adapter into the opening ensuring the adapter is completely in place until the bottom edge of the adapter bottoms out on the top of the bead edge inside the fireplace flue.

Align the Adapter with the four (4) holes on the fireplace top.

Secure the Adapter to the fireplace using the screws provided.

7" CF ADAPTER/CHIMNEY INSTALLATION

(Model CF)

Place the adapter on the fireplace, see Chimney Adapter Installation.

Remove the plastic retainer from the CF chimney to expose the insulation.

Mount four (4) "L" brackets flush with end edge of casing and secure with #6 x 3/4" stainless sheet metal screws. Two per bracket.

Position CF chimney on coupler adapter of fireplace. Drill 3/32" holes thru holes in "L" brackets into top and secure with #6 x 3/4" stainless sheet metal screws. Two per bracket.

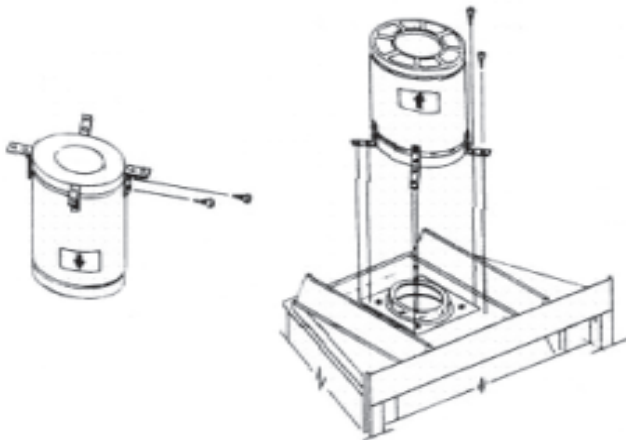

EXTERIOR CHIMNEY INSTALLATIONS

On a through the wall installation as shown in figures 11c and 14c, an intermediate wall support is required immediately above the second elbow which will support up to 10m (30ft.) of chimney.

Install one length of chimney on the second elbow and secure in place with a locking band. Assemble the intermediate wall support and slide the assembly over the section just installed. Fasten the intermediate wall support to the wall using four 1/4 x 2" lag bolts, or wood screws so that the hole in the plate is located in the middle of the chimney section. Install the draw band around the chimney so that it is securely against the support plate and supporting the weight of the chimney. Install four sheet metal screws firmly into the outer casing of the chimney, through the pre-punched holes in the draw band. See figure 25.

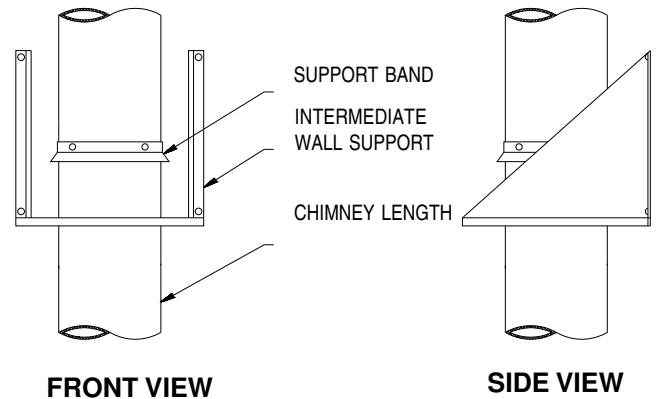

FIGURE 25

Wall bands must then be installed at 2.4m(8ft.) intervals above the intermediate wall support.

Using the nut and bolt supplied, fasten the wall band around the chimney section. Then secure the band to the wall using two 6d(2") spiral nails or appropriate masonry fasteners for concrete walls.

ROOF FLASHING INSTALLATION

Ensure that you have the proper roof flashing by checking your roof pitch using a level and two rulers, or by using a roof pitch card. See figure 26.

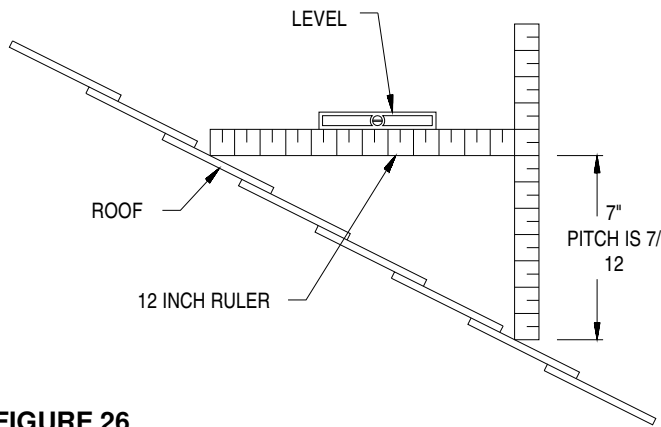

FIGURE 26

A Rafter Radiation Shield is only required when the chimney is enclosed in the attic space. The shield is installed from above the joist and is supported by the two L-shaped brackets on the sides. Ensure that the chimney is plumb, then nail the rafter radiation shield into place through the brackets before the roof flashing is installed. See figure 27.

Slide the roof flashing suitable to your roof pitch over the chimney. Place the top edge of the flashing plate under the shingles. Place both sides and bottom edge on top of shingles. See figure 27.

Square up the flashing plate and nail in place to the roof deck using 12 nails with neoprene washers or cover the heads with a suitable water proof mastic.

Wrap the storm collar around the chimney above the flashing, and secure the ends loosely together with the nut and bolt supplied. Slide the collar down the chimney until it contacts the flashing guides. Tighten the nut and bolt and seal the storm collar to the chimney with a suitable non-combustible mastic.

The flashing and storm collar should be painted to match the roof shingles. This will extend its life and improve the appearance of the installation. Clean, prime, and paint with suitable painting products.

Continue adding chimney lengths until the proper height is achieved. See Chimney Installation Instructions on page 3. Install a raincap (Standard, or Deluxe Model for Supervent models) and lock it into place by turning it clockwise until tight or by tightening the nut and bolt of a Round Top Selkirk Model.

If the chimney extends more than 1.6m(5ft.) above the roof deck, then roof guys are required. An adjustable roof brace kit is suitable for this application. The draw band must be clamped around the chimney and the two legs bolted to the chimney.

WARNING: DO NOT BLOCK THE VENTILATION OPENINGS IN THE FLASHING.

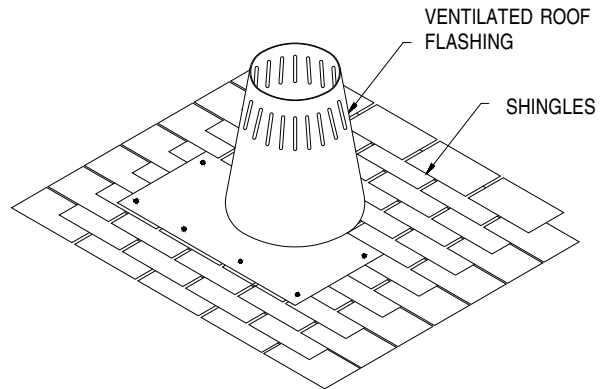
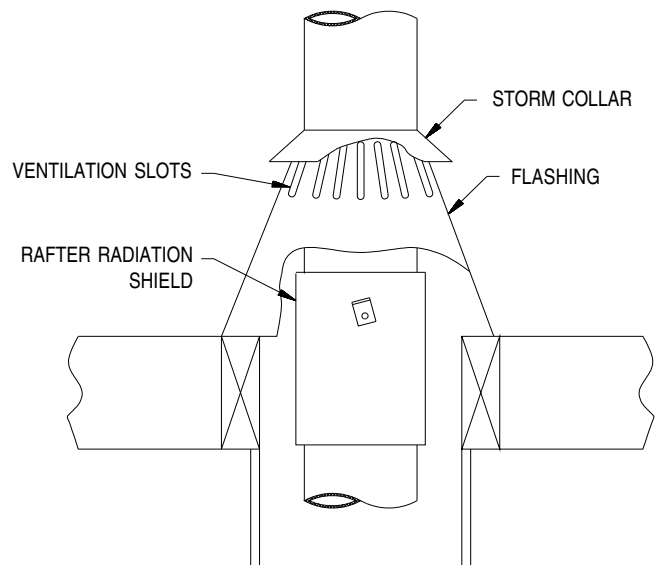

FIGURE 27



NOTE: AT THE TOP EDGE OF THE FLASHING PLATE, LIFT THE SHINGLES AND NAIL THE PLATE TO THE ROOF DECK. THEN CEMENT THE SHINGLES TO THE PLATE WITH A SUITABLE WATERPROOF MASTIC.