

INSTALLATION INSTRUCTIONS

Installation And Operating Instructions

*For Superior's
G400 Series
Vented Decorative
Gas Appliances*

*Models
G400N
G400NE*

For Use In U.S.A.

This installation manual will help you obtain a safe, efficient, dependable installation for your gas appliance and vent system. Please read and understand these installation instructions before beginning your installation.

WARNING: THE G400 SERIES FIREPLACES ARE VENTED DECORATIVE GAS APPLIANCES. THEY ARE NOT INTENDED TO BE USED AS A SPACE HEATER. DO NOT BURN WOOD OR OTHER MATERIAL IN THESE APPLIANCES

Do not attempt to alter or modify the construction of the fireplace or its components. Any modification or alteration of construction may void the warranty, certification and approvals of these units.

The G400 Series appliances are designed to be installed with standard B vent ducting in accordance with the vent manufacturers installation instructions and local and national codes.

WARNING: IMPROPER INSTALLATION, ADJUSTMENT, ALTERATION, SERVICE OR MAINTENANCE CAN CAUSE INJURY OR PROPERTY DAMAGE. REFER TO THIS MANUAL. FOR ASSISTANCE OR ADDITIONAL INFORMATION CONSULT A QUALIFIED INSTALLER, SERVICE AGENCY OR THE GAS SUPPLIER.

FOR YOUR SAFETY

What to do if you smell gas:

- Extinguish any open flame.
- Open windows.
- DO NOT light any appliance.
- DO NOT touch any electrical switches.
- DO NOT use any phone in your building.
- Immediately call your gas supplier from a neighbor's phone.
- If your gas supplier cannot be reached, call the fire department.

FOR YOUR SAFETY

Do not store or use gasoline or other flammable vapors or liquids in the vicinity of this or any other appliance.

Due to high temperatures, the appliance should be located out of traffic and away from furniture or drapes.

Do not place clothing or other materials on or near the appliance.

PLEASE RETAIN THIS MANUAL FOR FUTURE REFERENCE.



TABLE OF CONTENTS

General Information	page 2
Introduction	page 2
Special Packaging	page 2
Location	page 2
Clearances	page 3
Assembly Steps	page 3
Installation Steps	page 3
Wiring - Millivolt	page 4
Wiring - Electronic	page 4
Gas Line Installation	page 5
Control Compartment Access Panel	page 5
Cold Climate Insulation	page 5
High Elevation Derating	page 5
Optional Equipment	page 5
Combustion Air Kit	page 5
Remote Control Kit	page 6
Glass Doors/Enclosure Panels	page 6
Glass Door Precautions	page 6
Finished Wall Details	page 6
Appliance Operation - Millivolt	page 6
Appliance Operation - Electronic	page 7
Operation/Maintenance Instructions	page 7
Flame Appearance and Sooting	page 7
Main Burner Adjustment	page 7
Maintenance	page 7
Cleaning the Burner	page 7
Pilot Cleaning/Adjustments	page 8
Warranty	page 8
Troubleshooting	page 8
Replacement Parts	page 8
Accessories/Components	page 9
Appliance Specifications	page 10
Lighting Instructions - Millivolt	page 12
Lighting Instructions - Electronic	page 13
Troubleshooting Guide - Millivolt	page 14
Troubleshooting Guide - Electronic	page 15
Replacement Parts List - Millivolt	page 16
Replacement Parts List - Electronic	page 18

GENERAL INFORMATION

These appliances comply with National Safety Standards and are tested and listed by AGA to ANSI Z21.50b as a vented decorative gas appliances.

Installation must conform to local codes. In the absence of local codes, installation must conform with the current National Fuel Gas Code, ANSI Z223.1. The appliance when installed, must be electrically grounded in accordance with local codes or with the National Electric Code, ANSI/NFPA No. 70-1994.

Note: Installation and repair should be done by a qualified service person. The appliance should be inspected annually by a qualified professional service person. More frequent inspections and cleanings may be required due to excessive lint from carpeting, bedding material, etc. It is imperative that the control compartment, burners and circulating air passage ways of the appliance be kept clear.

Always provide for adequate ventilation.

Provide adequate clearances around air openings and adequate accessibility clearance for service and proper operation. Never obstruct the front opening of the appliance.

These systems have been designed to operate on natural gas or propane gas (if converted) only. The use of other fuels or combinations of fuels will degrade the performance of these systems.

Minimum inlet gas pressure is 4.5 inches water column for the purpose of input adjustment (natural gas).

Maximum inlet gas supply pressure is 10.5 inches water column (natural gas).

Input of appliance is 15,000 BTU/HR.

A 1/8" NPT plugged tap is provided on the gas control valve alongside of the outlet to the main burner for a test gage connection.

These appliances must not be connected to a chimney flue serving a separate solid fuel burning appliance.

These appliances must be isolated from the gas supply piping system by closing the individual manual shut-off valve during any pressure testing of the gas supply piping system at test pressures equal to or less than 10.5 inches water column (.4 psig or 2.8kPa).

The appliance and its individual shut-off valve must be disconnected from the gas supply piping system during any pressure testing of that system at test pressures in excess of 10.1 inches water column (.4psig) or 2.8kPa.

INTRODUCTION

This manual covers the installation of the G400N and G400NE systems.

When these appliances are installed directly on carpeting, tile or other combustible material other than wood flooring, the appliances shall be installed on a metal or wood panel extending the full width and depth of the appliance.

Do not use these appliances if any part has been under water. Immediately call a qualified service technician to inspect the appliance and to replace any parts of the control system and any gas control which have been under water.

SPECIAL PACKAGING

These appliances are shipped with the gas valve and burner tray assemblies installed and pre-wired at the factory. The burner tray is held in place by four (4) screws that secure it to the bottom of the appliance firebox. The logs are individually packaged and have been positioned directly above the burner tray. This packaging must be removed before installation can begin.

LOCATION

In selecting the location, the aesthetic and functional use of the appliance are primary concerns. However, vent routing to the exterior and access to the fuel supply are also important. Consideration should be given to traffic ways, furniture, draperies, etc., due to elevated surface temperatures. The location should also be free of electrical, plumbing or other heating/air conditioning ducting.

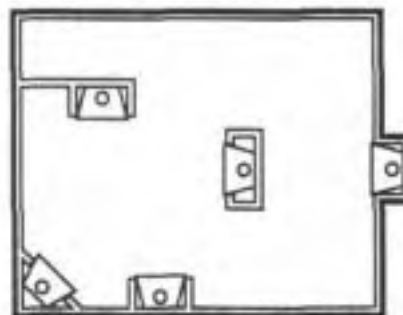

Figure 1

Remote Control Kit

wireless remote control kit, Model RCK, can be used in lieu of a manual ON/OFF wall switch. The kit consists of a receiver and a hand held transmitter. The receiver can be operated either in a manual ON/OFF mode or in the remote position. Both the receiver and transmitter operate on 9 volt batteries (not supplied by Superior). Refer to the wireless remote control switch installation instructions (P/N 095002) for specific installation details.

Glass Doors/Enclosure Panels

Several models of optional glass doors/panels are available for installation on this gas appliance. Use glass door Models 33BF-PB, 33BF-ABR, 33BF-SPB, 33C-SPB, 33S8F-BR (requires the SBF-DSK33) and 33GEP-SPB. Refer to the specific installation instructions packed with each glass door assembly for installation details.

GLASS DOOR/PANEL OPERATING PRECAUTIONS AND INSTRUCTIONS

- Never clean glass when doors or panel is hot due to operating appliance.
- Glass and metal frames get hot. Use only the wooden handles to open and close the doors or to lift out panel.



Figure 17

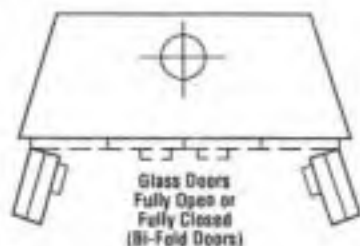

Figure 18

CAUTION: THE APPLIANCE SHOULD ONLY BE OPERATED WITH THE DOORS FULLY OPEN OR FULLY CLOSED.

FINISHED WALL DETAILS

It is sometimes best to frame the appliance after it has been positioned in place. Frame with 2 x 4s or heavier lumber. Always frame in accordance with local building codes.

Note: The header may rest on the top spacers but must not be notched to fit around them.

In order to install the appliance facing flush with the finished wall, position the framework to accommodate the thickness of the finished wall (Figure 19).

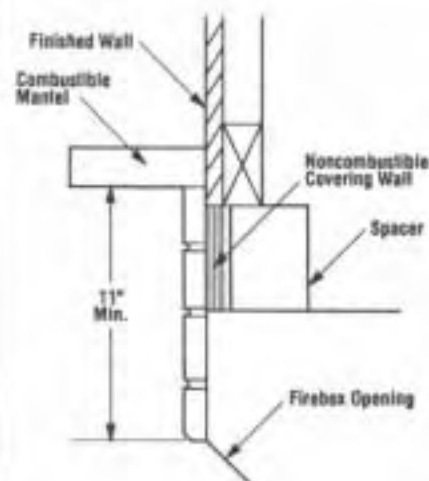

Figure 19

Surround materials can be placed around the appliance facing to provide a flush surface between the surround materials and the appliance front facing (Figure 19).

It is NOT necessary to install a hearth extension with this appliance. Any hearth extension used is for appearance only and does not have to conform to standard hearth extension installation specifications.

A combustible mantel shell projecting a maximum 8" from the wall may be installed a minimum of 11" above the G400 appliance front opening (Figure 20).

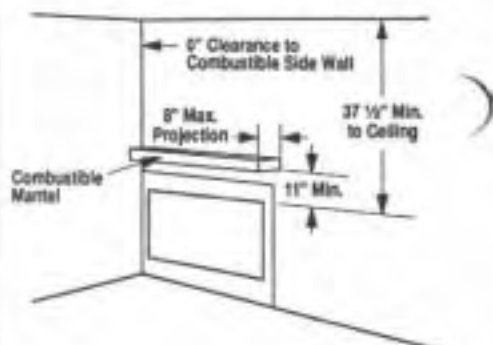

Figure 20

WARNING: CHILDREN AND ADULTS SHOULD BE ALERTED TO THE HAZARDS OF HIGH SURFACE TEMPERATURES AND SHOULD STAY AWAY TO AVOID BURNS OR CLOTHING IGNITION. YOUNG CHILDREN SHOULD BE SUPERVISED WHEN THEY ARE IN THE SAME ROOM AS THE APPLIANCE.

APPLIANCE OPERATION Millivolt

To operate the appliance, refer to the lighting instructions identified on page 12 or on the back of the control compartment access panel.

The G400N gas control system is a millivolt standing pilot type. It consists of a pilot burner, a gas control valve and a burner assembly. A temperature limit switch is wired to the gas control valve. If a higher than normal temperature is sensed due to a blocked vent or prolonged downdraft, the limit switch will open and cause the burner to shut off.

To obtain proper operation, it is important that the pilot and main burner flames are steady, not lifting or floating.

The top of the pilot generator (thermopile) (approximately 3/8" to 1/2") should be engulfed in the pilot flame (Figure 21).

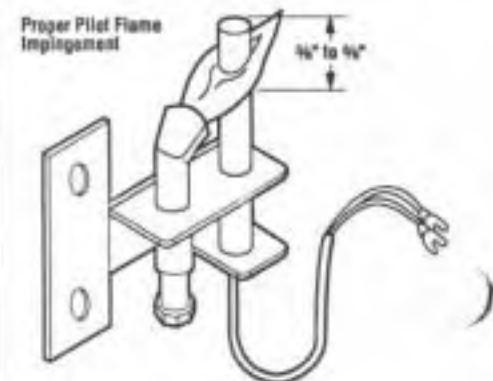

Figure 21

Electronic

To operate the appliance, refer to the lighting instruction identified on page 13 or on the back of the control compartment access panel.

The G400NE gas control system is a direct spark ignition type. There is no standing pilot. The system consists of a direct spark igniter, igniter control and electronic valve. The system is operated by a low voltage wall switch. Power is supplied from standard house wiring through a transformer that is part of the unit. A temperature limit switch is wired to the igniter control. If a higher than normal temperature is sensed, usually due to a blocked vent or prolonged downdraft, the limit switch will open and cause the burner to shut off.

To obtain proper operation, it is important that the main burner flames are steady, not lifting or floating.

OPERATION GUIDELINES AND MAINTENANCE INSTRUCTIONS

1. Upon completing the gas line connection, a small amount of air will be in the lines. When first lighting the appliance, it will take a few minutes for air to be purged from the lines. Once purging is complete, the pilot (Model G400N only) and burner will light and operate as indicated in the instruction manual. Subsequent lightings of the appliance will not require such purging.

2. When lit for the first time, the appliance will emit a slight odor for an hour or two. This is due to the "curing" of the logs and "burn-off" of internal paints and lubricants used in the manufacturing process.

3. Keep the control compartment, logs, burners and area surrounding the logs clean by vacuuming or brushing at least twice a year.

CAUTION: THE GAS LOGS CAN GET VERY HOT — HANDLE ONLY WHEN THE LOGS ARE COOL

4. Always shut off gas at the control valve before cleaning begins. Before re-lighting, refer to the lighting instructions.

5. This appliance and its venting system should be inspected before use and at least annually by a qualified service person.

6. Always keep the appliance area clear and free from combustible materials, gasoline and other flammable liquids.

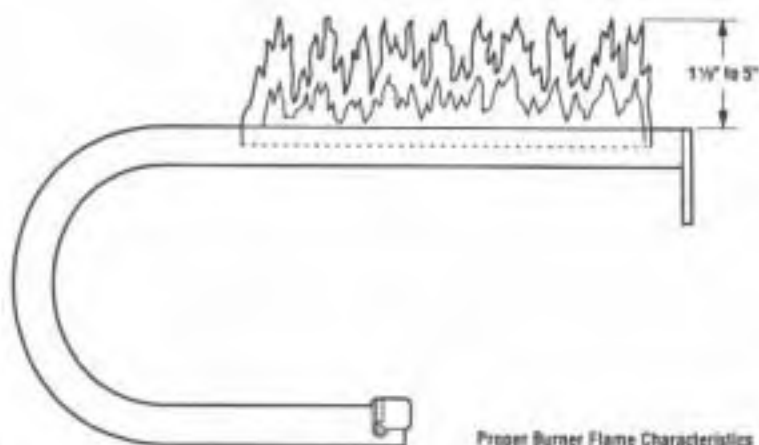

Figure 22

7. Never obstruct the flow of ventilation air. Keep the front of the appliance clear of all obstacles and materials.

8. The air shutters on the venturi have been set to the closed position for both natural and propane gas. If extensive sooting occurs and persists, especially with propane, adjust the venturi shutter open until the sooting stops.

Flame Appearance and Sooting

Proper flame appearance is a matter of taste. Generally most people prefer the warm glow of a yellow to orange flame. Appliances operated with air shutter openings that are too large will exhibit flames that are blue and transparent. These weak, blue and transparent flames are termed anemic. If the air shutter opening is too small sooting may develop. Sooting is indicated by black puffs developing at the tips of very long orange flames. Sooting results in black deposits forming on the logs, appliance inside surfaces and on exterior surfaces adjacent to the vent termination. Sooting is caused by incomplete combustion in the flames and a lack of combustion air entering the venturi air shutter opening. To achieve a warm yellow to orange flame with an orange body that does not soot, the shutter opening must be adjusted between these two extremes.

No smoke or soot should be present. Flames should reach the heights and appear as shown in Figure 22. Reposition the logs as shown in Figure 15 if the flames impinge on any of them.

CAUTION: DO NOT ATTEMPT TO REDUCE OR ALTER THE FLAME BY POSITIONING THE GAS VALVE IN OTHER THAN THE FULL "ON" POSITION.

If sooting conditions exist, the air shutter opening on the main burner venturi can be adjusted. Normally, the more offsets in the vent system, the greater the need for the air shutter to be opened further.

Main Burner Adjustment

Adjustment should be performed by a qualified professional service technician.

Maintenance

IMPORTANT: TURN OFF GAS AND ELECTRICAL POWER BEFORE SERVICING THE APPLIANCE. IT IS RECOMMENDED THAT A COMPETENT TECHNICIAN PERFORM THESE CHECK-UPS AT THE BEGINNING OF EACH HEATING SEASON.

In order to properly clean the burner and pilot assembly (if employed), remove the glass enclosure panel, if used, or open the glass doors, if installed, and remove the logs to expose the burner and pilot assembly (if present).

Cleaning the Burner

Clean all foreign materials from the top of burner (take care so as not to disturb or displace the mineral fiber) and from bottom compartment below the burner. Check to ensure that the burner orifice is clean.

Pilot Cleaning and Adjustments (G400N only)

Visually inspect the pilot. Brush or blow away any dust or lint accumulations. If the pilot orifice is plugged, disassembly may be required to remove any foreign material from the orifice or tubing. When appliance is put back in service, check the pilot flame patterns with *Figure 21*.

Adjust the pilot flame as follows:

1. Remove the pilot adjustment cap located on the main gas valve.
2. Adjust the pilot screw to provide properly sized pilot flame (*Figure 21*). Turn counter clockwise to enlarge pilot flame and clockwise to reduce the pilot flame. DO NOT attempt to adjust pilot flame more than one half turn.
3. Replace the pilot adjustment cap.

WARRANTY

This gas appliance is covered by a one year limited warranty. You will find a copy of this warranty in the back of this manual. Please read the warranty to be familiar with its valuable coverage and file it with others you save for future reference.

TROUBLESHOOTING

With proper installation and maintenance, your new gas appliance (fireplace) should provide years of trouble free service. If you do experience a problem, trouble shooting guides are provided in this manual. These guides will assist you or a qualified service person in the diagnosis of problems and the corrective action to be taken.

REPLACEMENT PARTS

Contact the factory or distributor for questions concerning prices and policies covering replacement parts. Parts will be shipped at prevailing prices. Normally, all parts can be ordered through your Superior distributor or servicing dealer.

When ordering repair parts, always give the following information:

1. The model number of the appliance
2. The part number of repair part
3. The description of the part
4. The installation date of appliance

If you encounter any problems or have any questions concerning the installation or application of this system, please contact your distributor. For your nearest distributor contact:

SUPERIOR FIREPLACE COMPANY
4325 Artesia Avenue
Fullerton, California 92633
(714) 521-7302

Model	Part Number	Weight
G400N	P/N 062301	51 lbs.
G400NE	P/N 062302	53 lbs.

ACCESSORIES AND COMPONENTS

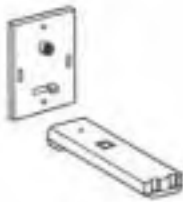

Remote Control Kit P/N 035591 RCK

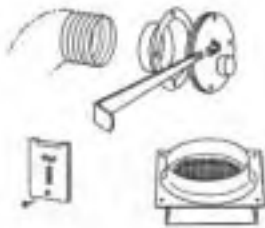

Combustion Air Kit P/N 011768 GAK-400

Note: The "Bi-fold" Series glass doors overlap the frame around the fireplace. Allow 1/4" clearance: top, bottom and each side when applying facing materials.



"ALL-GLASS™"
Bi-Fold P/N 027631 33BF-PB
P/N 026961 33BF-SPB
P/N 027637 33BF-ARR

Note: The "C" Series glass doors overlap the frame around the fireplace. Allow 1/4" clearance on each side and 1 1/4" clearance on top and bottom when applying facing materials.



"ALL-GLASS™" P/N 038951 33C-SPB

Note: The "Bi-fold" Series glass doors overlap the frame around the fireplace. Allow 1/4" clearance: top, bottom and each side when applying facing materials.



"ALL-GLASS™"
Aluminum P/N 037831 33SBF-BR



Door Step Kit P/N 038641 SBF-DSK33



"ALL-GLASS™"
Enclosure Panel P/N 043551 33GEP-SPB



High Altitude Derating Kit P/N 102791 HAKK-400N
P/N 102792 HAKK-400P



LP Conversion Kit P/N 083432

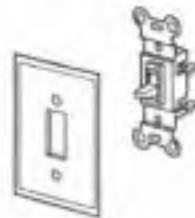

Wall Switch Kit P/N 102831 WSK-400

APPLIANCE SPECIFICATIONS

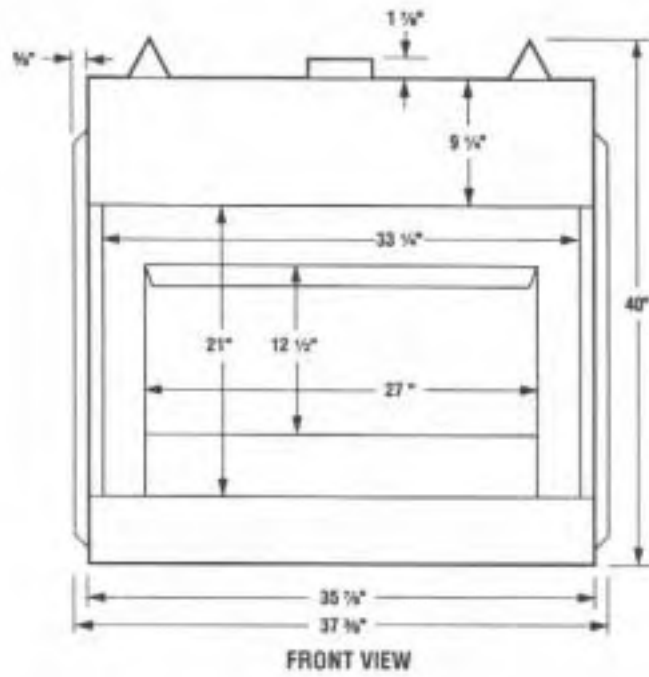

Figure 23

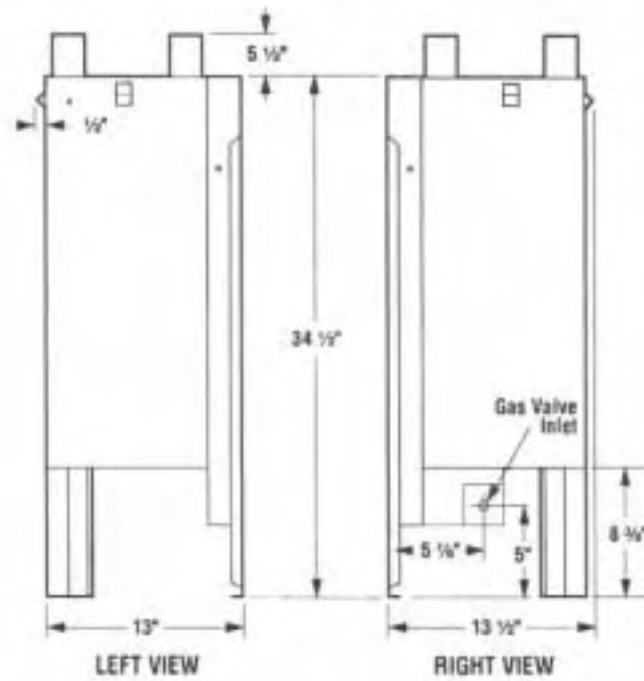

Figure 24

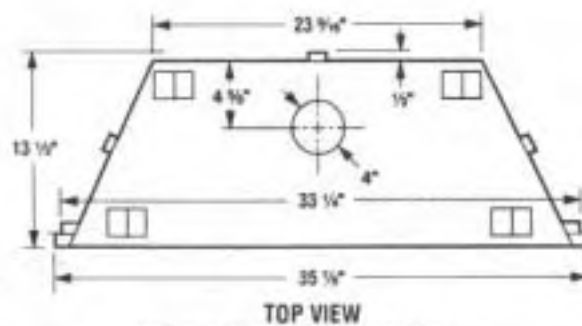

Figure 25

NOTE: DIAGRAMS & ILLUSTRATIONS NOT TO SCALE.

☺

!

☺

!

☺

G400N — MILLIVOLT LIGHTING INSTRUCTIONS

FOR YOUR SAFETY READ BEFORE LIGHTING

WARNING: IF YOU DO NOT FOLLOW THESE INSTRUCTIONS EXACTLY, A FIRE OR EXPLOSION MAY RESULT CAUSING PROPERTY DAMAGE, PERSONAL INJURY OR LOSS OF LIFE.

- A.** This appliance has a pilot which must be lighted by hand. When lighting the pilot, follow these instructions exactly.
- B. BEFORE OPERATING** smell all around the appliance area for gas. Be sure to smell next to the floor because some gas is heavier than air and will settle on the floor.

WHAT TO DO IF YOU SMELL GAS

- Do not try to light any appliance.
- Do not touch any electric switch; do not use any phone in your building.

- Immediately call your gas supplier from a neighbor's phone. Follow the gas supplier's instructions.
 - If you cannot reach your gas supplier, call the fire department.
- C.** Use only your hand to push in or turn the gas control knob. Never use tools. If the knob will not push in or turn by hand, do not try to repair it, call a qualified service technician. Force or attempted repair may result in a fire or an explosion.
- D.** Do not use this appliance if any part has been under water. Immediately call a qualified service technician to inspect the appliance and to replace any part of the control system and any gas control which has been under water.

LIGHTING INSTRUCTIONS

1. **STOP!** Read the safety information above on this page.
2. Set the wall switch (optional) to "OFF."
3. Open glass doors and remove the control compartment cover panel.
4. Depress gas control knob slightly and turn clockwise to "OFF." If knob is in "ON" position, turn clockwise to "PILOT" then depress knob slightly and turn clockwise to "OFF."

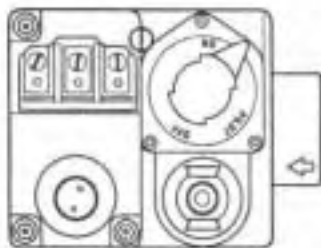

Note: Knob cannot be turned from "PILOT" to "OFF" unless the knob is pushed in slightly. Do not use tools or excessive force.

5. Wait fifteen (15) minutes to clear out any gas. If you then smell gas, STOP! Follow "B" in the safety information above on this page. If you do not smell gas, go to the next step.
6. Remove the front log and locate the pilot.
7. Turn knob on gas control counterclockwise to "PILOT."
8. Depress control knob all the way and hold in. Immediately light the pilot with a match. Continue to hold the control knob in for about 1 minute after the pilot is lit. Release knob and it will pop back out. Pilot should remain lit. If it goes out, repeat steps 5, 6, 8 and 9.
 - If knob does not pop up when released, turn clockwise to "OFF," stop and immediately call your service technician or gas supplier.
 - If pilot will not stay lit after several tries, turn the control knob to "OFF" and call your service technician or gas supplier.
9. Turn gas control knob counterclockwise to "ON."
10. Replace control compartment cover panel. Replace front log.

TO TURN OFF GAS TO APPLIANCE

1. Turn off all electrical power to the appliance if service is to be performed.
2. Turn gas control knob clockwise to "PILOT."
3. Depress gas control knob slightly and turn clockwise to "OFF." Do not use tools or excessive force.

G400NE — ELECTRONIC LIGHTING INSTRUCTIONS

FOR YOUR SAFETY READ BEFORE LIGHTING

WARNING: IF YOU DO NOT FOLLOW THESE INSTRUCTIONS EXACTLY, A FIRE OR EXPLOSION MAY RESULT CAUSING PROPERTY DAMAGE, PERSONAL INJURY OR LOSS OF LIFE.

- A.** When lighting the appliance, follow these instructions exactly.
- B.** BEFORE OPERATING smell all around the appliance area for gas. Be sure to smell next to the floor because some gas is heavier than air and will settle on the floor.
- WHAT TO DO IF YOU SMELL GAS**
- Extinguish any open flame.
 - Open windows.
 - Do not light any appliance.
 - Do not touch any electrical switches.
 - Do not use any phone in your building.
- Immediately call your gas supplier from a neighbor's phone.
 - If your gas supplier cannot be reached, call the fire department.
- C.** Use only your hand to turn the gas control lever. Never use tools. If the lever will not turn by hand, do not try to repair it, call a qualified service technician. Force or attempted repair may result in a fire or an explosion.
- D.** Do not use this appliance if any part has been under water. Immediately call a qualified service technician to inspect the appliance and to replace any part of the control system and any gas control which has been under water.

LIGHTING INSTRUCTIONS

1. **STOP!** Read the safety information above on this page.
2. Turn remote wall switch to "OFF."
3. Remove lower control compartment access panel.
4. Verify main line shut-off valve is open.
5. Rotate the gas control lever to "OFF" (straight up). Do not force.
6. Wait five (5) minutes to clear out any gas. If you then smell gas, STOP! Follow "B" in the safety information above on this page. If you do not smell gas, go to the next step.
7. Rotate the gas control lever to "ON" (straight out). Do not force.
8. Turn "ON" all electrical power to appliance (remote wall switch).
9. Replace lower control compartment access panel.

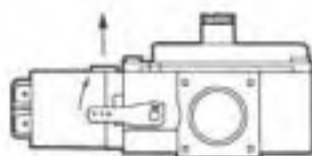

TO SHUT OFF

1. Turn off all electrical power to the appliance (remote wall switch).

TO TURN OFF GAS TO APPLIANCE

1. For complete shut-down, turn remote wall switch to "OFF."
2. Remove lower control compartment access panel.
3. Rotate the gas control lever to "OFF" (straight up). Do not force.
4. Close the main line shut-off valve.
5. Replace lower control compartment access panel.

TROUBLESHOOTING THE MILLIVOLT GAS CONTROL SYSTEM

MODEL G400N

Note: Before troubleshooting, be sure the external gas shut-off valve, located at the gas supply inlet, is in the "ON" position.

SYMPTOM	POSSIBLE CAUSES	CORRECTIVE ACTION
1. Pilot will not stay lit after carefully following lighting instructions.	A. Defective pilot generator (thermopile) or remote wall switch wiring.	<ol style="list-style-type: none"> 1. Check pilot flame. It must impinge on pilot generator (Figure 21). Clean and/or adjust pilot for maximum flame impingement on generator. 2. Be sure wire connections from generator at gas valve terminals are tight and generator is fully inserted into the pilot bracket. 3. One of the wall switch (optional) wires may be grounded. Remove wall switch wires from valve terminals. If pilot now stays lit, trace wall switch wires for a ground. May be grounded to appliance or gas supply. 4. Check pilot generator with a millivolt meter. Take reading at generator terminals of gas valve. Should read 325 millivolts minimum while holding valve knob depressed in pilot position and wall switch "OFF." Replace faulty generator if reading is below specified minimum.
	B. Defective Automatic valve operator.	<ol style="list-style-type: none"> 1. Turn knob to "ON," place wall switch to "ON." Millivolt meter should read greater than 100mV. If reading is OK and the burner does not come on, replace the gas valve.
2. Pilot burning, no gas to burner, valve knob "ON," wall switch "ON."	A. Wall switch or wires defective.	<ol style="list-style-type: none"> 1. Check wall switch and wires for proper connections. Jump wires for proper connections. Place jumper wires across terminals at wall switch. If burner comes on, replace defective wall switch. If OK, place jumper wires across wall switch wires at gas valve. If burner comes on, wires are defective or connections are bad.
	B. Pilot generator may not be generating sufficient millivoltage.	<ol style="list-style-type: none"> 1. Re-check Symptom #2.
	C. Plugged burner orifice.	<ol style="list-style-type: none"> 1. Check burner orifice for blockage and remove.
3. Frequent pilot outage problem.	A. Pilot flame may be too low or blowing (high) causing the pilot safety to drop out.	<ol style="list-style-type: none"> 1. Clean/adjust pilot flame for maximum impingement on pilot generator (Figure 21).

TROUBLESHOOTING THE DIRECT SPARK IGNITION ELECTRONIC SYSTEM

MODEL G400NE

Note: Before troubleshooting, be sure that the appliance main line gas shut-off valve, the gas control valve and the wall switch are in the "ON" position.

Important: "ON/OFF" switch must be "OFF" before performing continuity test. Adjust multimeter to the ohm setting when performing continuity tests.

SYMPTOM	POSSIBLE CAUSES	CORRECTIVE ACTION
1. No spark.	A. Faulty transformer.	Confirm 24Vac output from transformer (red and blue leads). If no, then replace transformer. <i>Note:</i> Before replacing transformer, check wiring for loose connections or broken wires and repair as needed. Turn off electricity before replacing transformer.
	B. Faulty limit switch.	Remove wire nuts from black leads attached to the limit switch and check for continuity. If no continuity, replace limit switch.
	C. "ON/OFF" switch (optional) defective.	Disconnect the two black wires from the wire nuts. Test "ON/OFF" wall switch for continuity with a multimeter. If continuity is not indicated, switch is defective and must be replaced. <i>Note:</i> Before replacing "ON/OFF" switch, be sure to check wiring for loose connections or broken wires and repair as needed.
	D. Ignition control module defective.	If red light on ignition control remains on continuously, replace ignition control module.
	E. Ignition control or igniter defective.	Confirm that the igniter electrode is sparking to the burner tube when the "ON/OFF" switch is activated and that the gap is as indicated in Step 2A. If not, undertake the following steps: With "ON/OFF" switch "OFF," remove wire at "TR" terminal at the ignition control module. Disconnect the electrode wire from the terminal located at the ignition control. Connect one end of a jumper wire to the metal blade of a small screwdriver. Attach the other end of the jumper wire to any metal part of the chassis. Reconnect the "TR" terminal. Position end of metal blade approximately 1/8" from the terminal. Activate the "ON/OFF" switch. Sparking should occur between the terminal and screwdriver blade. If sparking does occur, the ignition control module is OK. Check if the electrode wire or the igniter is faulty. If faulty, the igniter assembly should be replaced.
2. Igniter sparking but main burner will not light. <i>Note:</i> Ensure that both the unit control gas valve and the gas shut-off valve (part of the house gas line plumbing) are open.	A. Improper alignment of igniter electrode.	It is critical that the gap between the burner tube and the electrode tip be 3/64" to 5/64" (.109" to .141"). Approximately 1" of the electrode should be engulfed in the flame. Incorrect gap and closed gas valves may also cause lack of ignition and a blinking red light on the ignition control module.
	B. Burner orifice plugged.	Check main burner orifice(s) for stoppage. Clean or replace.
	C. Gas valve defective.	Check for 24 volts at gas valve terminals "1" and "2." If there is a 24V reading during the ignition trial and the burner does not come on, the valve is defective and the gas valve must be replaced.
3. Burner comes "ON" but goes "OFF."	A. Igniter not correctly positioned.	Check location of igniter and adjust as in Step 2A above.

REPLACEMENT PARTS LIST — MILLIVOLT SYSTEM

No.	Description	G400N	
		Part No.	Qty.
1.	Log, Front	062711	1
2.	Log, Rear	062712	1
3.	Burner Tube	900794	1
4.	Burner Support	062411	2
5.	Log Fender	005704	1
6.	Pilot Bracket	062391	1
7.	Log Bracket	062381	2
8.	Pilot Assembly	900739	1
9.	Base, Firebox	900739	1
10.	Bracket, Valve	062361	1
11.	Panel, Screen/Pull	090673	2
12.	Screen Rod	062441	1
13.	Control Cover	062421	1

WHITE RODGERS CONTROLS — MILLIVOLT SYSTEM

No.	Description	G400N	
		Part No.	Qty.
20.	Gas Control Valve (36C03U-100)	900738	1
21.	Orifice, Burner (Natural #49)	094122	1
22.	Orifice, Pilot (Natural, .018)	901508	1
23.	Orifice Derating Kit	102791	1
24.	Limit Switch	900894	2
25.	Pilot Generator, TP-75	094699	1

REPLACEMENT PARTS

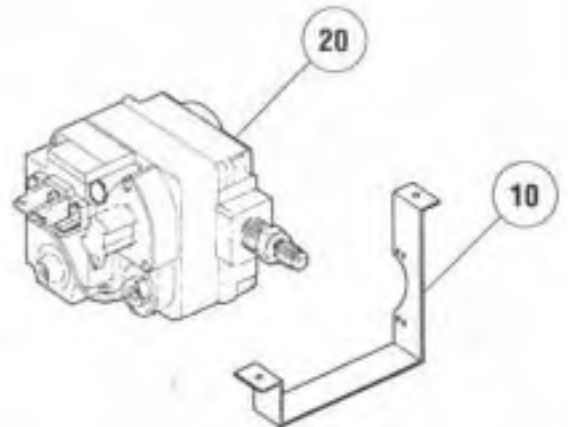
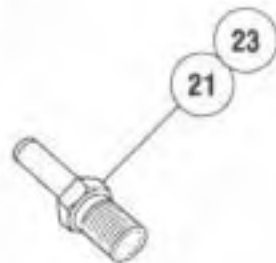
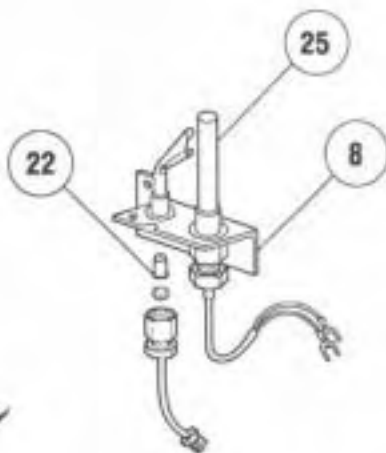
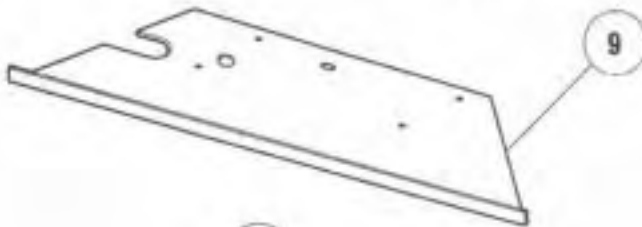
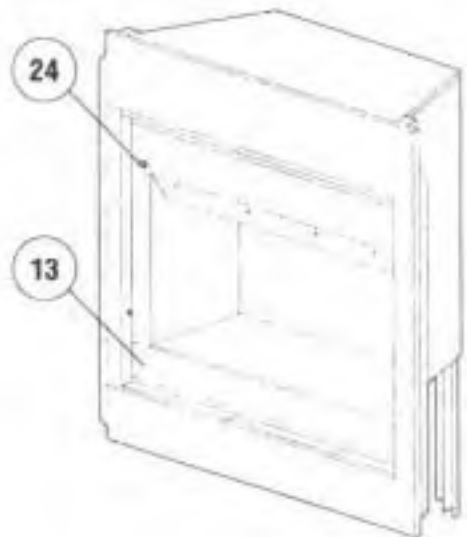
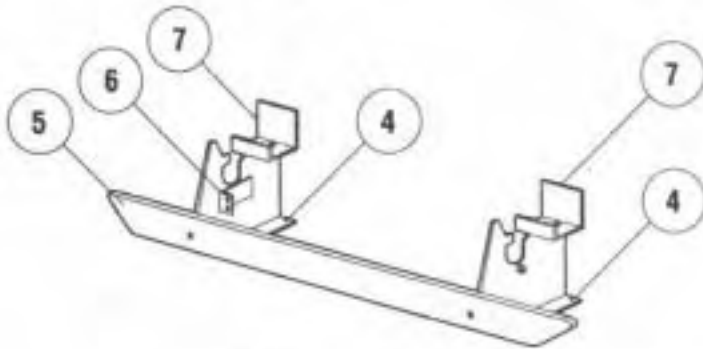
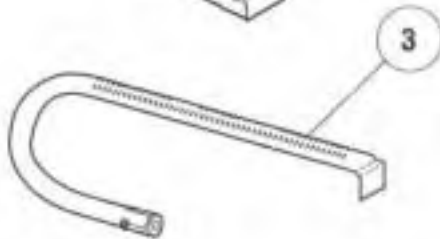
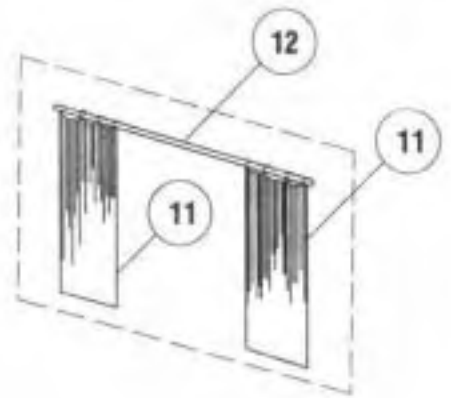
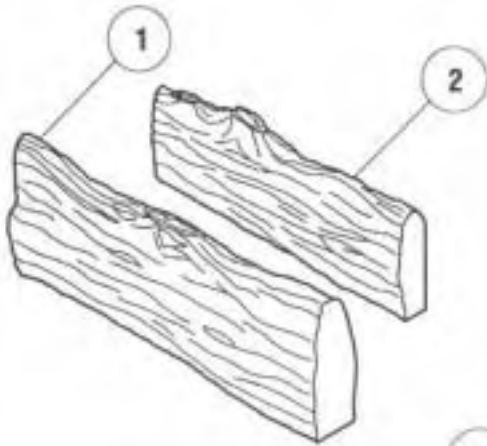

NOTE: DIAGRAMS & ILLUSTRATIONS NOT TO SCALE.

REPLACEMENT PARTS LIST — ELECTRONIC SYSTEM

No.	Description	G400NE	
		Part No.	Qty.
1.	Log, Front	062711	1
2.	Log, Rear	062712	1
3.	Burner Tube	102591	1
4.	Burner Support	062411	2
5.	Log Fender	005704	1
6.	Log Bracket	062381	2
7.	Base, Firebox	900739	1
8.	Bracket, Control	102331	1
9.	Bracket, Valve	102320	1
10.	Panel, Screen/Pull	090673	2
11.	Screen Rod	062441	1
12.	Control Cover	062421	1

ROBERTSHAW — ELECTRONIC SYSTEM (DIRECT SPARK)

No.	Description	G400NE	
		Part No.	Qty.
20.	Gas Control Valve (7222DER)	901198	1
21.	Orifice, Burner (Natural #49)	094122	1
22.	Orifice Derating Kit	102791	1
23.	Limit Switch	900894	2
24.	Ignitor, Electronic	901451	1
25.	Transformer	040413	1
26.	Ignitor Controller, Electronic	901253	1

REPLACEMENT PARTS

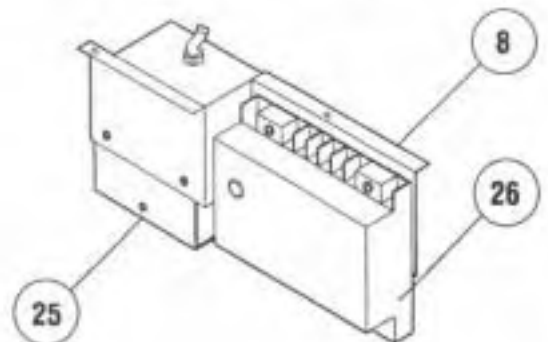
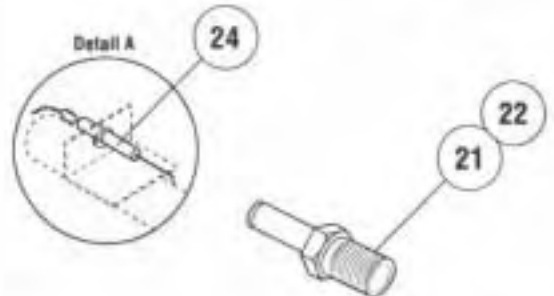
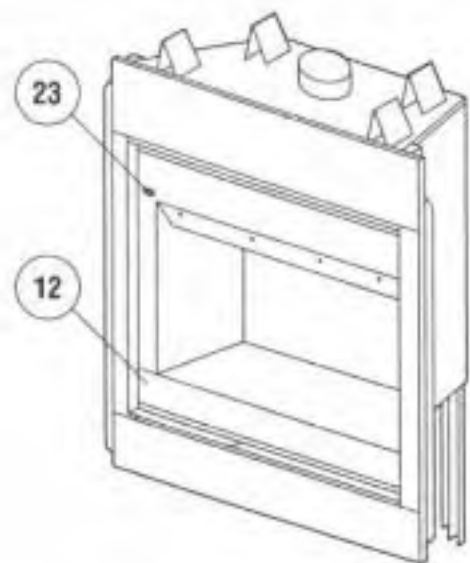
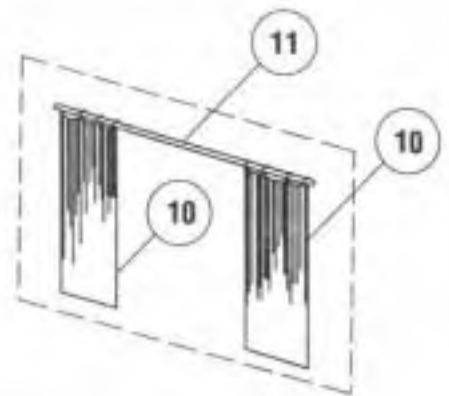
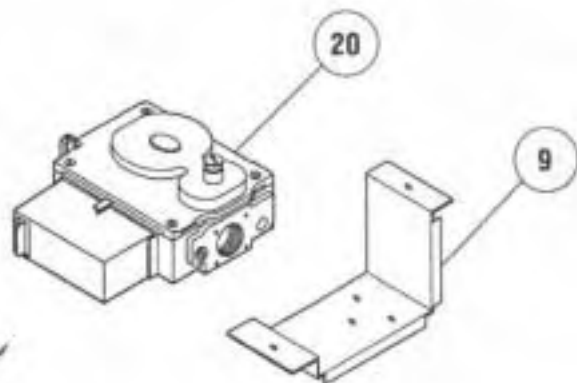
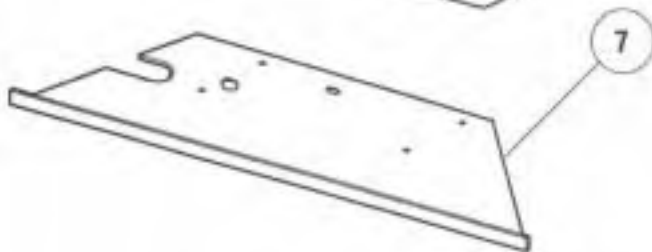
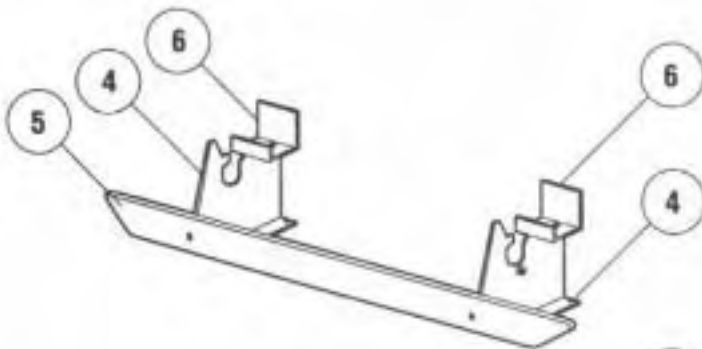
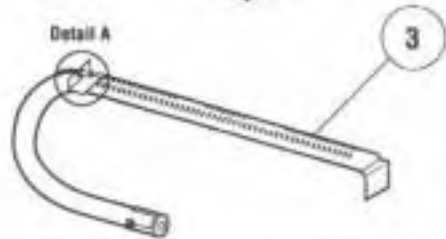
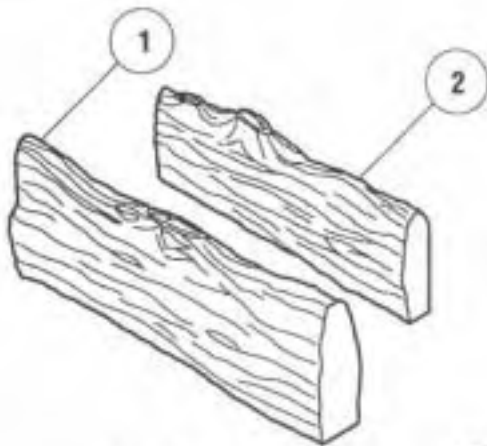

NOTE: DIAGRAMS & ILLUSTRATIONS NOT TO SCALE.

Superior G400 Series Gas Fireplaces Limited Warranty 1 Year

THE WARRANTY

Superior Fireplace Company warrants this G400 Series Vented Decorative Gas Appliance to be free from defects in materials and workmanship at the time of manufacture.

REMEDY AND EXCLUSIONS

The coverage of this Warranty is limited to all components of the vented decorative gas appliance manufactured by Superior Fireplace Company, with the exception of ceramic fiber logs and Superior glass enclosure panels. A separate limited warranty for Superior enclosure panels is available from Superior Fireplace Company for all glass enclosure panels manufactured by Superior Fireplace Company.

This warranty only covers Superior vented decorative gas appliances installed in the United States or Canada.

If the vented decorative gas appliance covered by this Warranty is found to be defective within one year from the date of installation (see Superior's right of investigation outlined below), Superior will, at its option, replace or repair defective components of the vented decorative gas appliance manufactured by Superior Fireplace Company at no charge and will also pay for reasonable labor costs incurred in replacing or repairing such components. If repair or replacement is not commercially practical, Superior will, at its option, refund the purchase price of the Superior vented decorative gas appliance. With respect to the glass enclosure panel, the remedies of this paragraph are available for 90 days from the date of installation.

This warranty covers only parts and labor as provided above. In no case shall Superior Fireplace Company be responsible for materials, components, or construction which are not manufactured or supplied by Superior Fireplace Company, or for the labor necessary to install, repair, or remove such materials or construction. All replacement or repair components will be shipped F.O.B. the nearest Superior Fireplace Company factory.

QUALIFICATIONS TO THE WARRANTY

The vented decorative gas appliance Warranty outlined above is further subject to the following qualifications:

(1) The vented decorative gas appliance must be installed in accordance with Superior Fireplace Company installation instructions and local building codes. The Warranty on this Superior vented decorative gas appliance covers only the component parts manufactured by Superior Fireplace Company. The use of components manufactured by others with this Superior vented decorative gas appliance (except for a listed venting system as prescribed in the installation instruction) could create serious safety hazards, may result in the denial of certification by recognized national safety agencies, and could be in violation of local building codes. This Warranty does not cover any damages occurring from the use of any components not manufactured or supplied by Superior Fireplace Company.

(2) The Superior vented decorative gas appliance must be subjected to normal use. The vented decorative gas appliances are designed to burn either natural or propane gas only. Burning conventional fireplace fuels such as wood, coal, or any other solid fuel will cause damage to the vented decorative gas appliance, will produce excessive temperatures and will result in a fire hazard.

LIMITATION ON LIABILITY

It is expressly agreed and understood that Superior Fireplace Company's sole obligation and purchaser's exclusive remedy under this warranty, under any other warranty, expressed or implied, or in contract, tort or otherwise, shall be limited to replacement, repair, or refund, as specified above.

In no event shall Superior Fireplace Company be responsible for any incidental or consequential damages caused by defects in its products, whether such damage occurs or is discovered before or after replacement or repair, and whether or not such damage is caused by Superior Fireplace Company's negligence. Some states do not allow the exclusion or limitation of incidental or consequential damages, so the above limitation or exclusion may not apply to you. The duration of any implied warranty with respect to this Superior vented decorative gas appliance is limited to the duration of the foregoing warranty. Some states do not allow limitations on how long an implied warranty lasts, so the above may not apply to you.

INVESTIGATION OF CLAIMS AGAINST WARRANTY

Superior Fireplace Company reserves the right to investigate any and all claims against this Warranty and to decide upon method of settlement.

SUPERIOR FIREPLACE COMPANY NOT RESPONSIBLE FOR WORK DONE WITHOUT WRITTEN CONSENT

Superior Fireplace Company shall not be responsible for any warranty work done without first obtaining Superior's written consent.

DEALERS HAVE NO AUTHORITY TO ALTER THIS WARRANTY

Superior Fireplace Company's employees and dealers have no authority to make any warranties not to authorize any remedies in addition to or inconsistent with those stated above.

HOW TO REGISTER A CLAIM AGAINST WARRANTY

In order for any claim under this Warranty to be valid, Superior Fireplace Company must be notified of the claimed defect in writing or by telephone to Superior Fireplace Company, attention Customer Service Department, 4325 Artesia Avenue, Fullerton, California 92603, telephone: 714-521-7300, as soon as reasonably possible after the defect is discovered. Claims against this Warranty in writing should include the date of installation, and a description of the defect.

OTHER RIGHTS

This Warranty gives you specific legal rights, and you may also have other rights which vary from state to state.

Superior reserves the right to make changes at any time, without notice, in design, materials, specifications, prices and also to discontinue colors, styles and products. Consult your local distributor for fireplace code information.